

FOR OFFICE USE ONLY

761027

CERTIFICATE OF REGISTRATION  
CERTIFICAT D'ENREGISTREMENT  
NIAGARA SOUTH/SUD (89)WELLAND

'99 04 9 13 37

*C. Hadley*

LAND REGISTRAR/REGISTRAR

New Property Identifiers

Additional:  
See  
Schedule ☐

Executions

Additional:  
See  
Schedule ☐

(1) Registry ☒ Land Titles ☐ (2) Page 1 of 9 pages

(3) Property Identifier(s) 64035-0311 (R) Block Property Additional:  
See  
Schedule ☐

(4) Nature of Document  
SITE PLAN AGREEMENT

(5) Consideration  
nil Dollars \$ 0.00

(6) Description  
Part of Lot 12, Concession 7, Town of Pelham, formerly Township of Pelham, designated as Parts 1 and 2 on Plan 59R-10468.  
As previously described in instrument No. R0755025 and being all of the P.I.N.

(7) This Document Contains: (a) Redescription New Easement Plan/Sketch ☐ (b) Schedule for: Description ☒ Additional Parties ☐ Other ☒

(8) This Document provides as follows:  
See Site Plan Agreement attached.

Continued on Schedule ☐

(9) This Document relates to instrument number(s)

(10) Party(ies) (Set out Status or Interest)  
Name(s) Signature(s) Date of Signature  
Y M D  
STEED & EVANS HOLDINGS INC.  
(Owner)

(11) Address for Service 300 Bridge Street East, Kitchener, Ontario, N2K 2B7

(12) Party(ies) (Set out Status or Interest)  
Name(s) Signature(s) Date of Signature  
Y M D  
THE CORPORATION OF THE TOWN OF PELHAM BROOKS, BIELBY & SMITH  
(Town/Applicant)  
by its Solicitors PER: 1999 04 08  
Brooks, Bielby & Smith  
(R. Bruce Smith)

(13) Address for Service P. O. Box 400, Fonthill, Ontario, L0S 1E0

(14) Municipal Address of Property  
not assigned

(15) Document Prepared by:  
R. Bruce Smith  
Brooks, Bielby & Smith  
247 East Main Street  
Welland, Ontario  
L3B 3X1

Fees and Tax	
Registration Fee	
Total	

SCHEDULE "A"

DESCRIPTION

Part of Lot 12, Concession 7, designated as Parts 1 and 2 on Reference Plan 59R-10468, in the Town of Pelham (formerly Township of Pelham), Regional Municipality of Niagara. As in Instrument R0755025.

P.I.N. NUMBER 64035-0311 (R)



SCHEDULE "B"

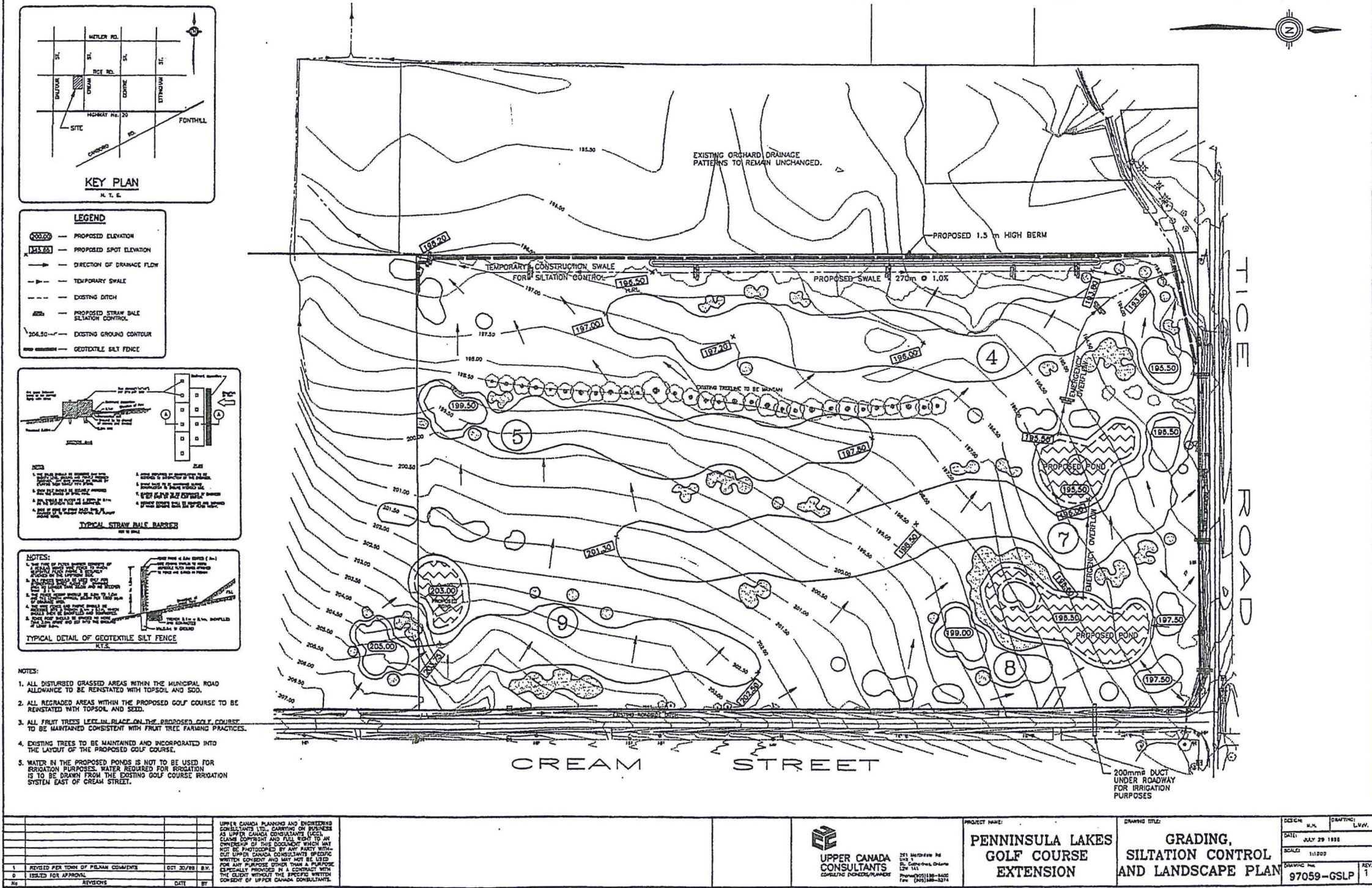

SCHEDULE " C "

DEPOSIT FOR FACILITIES AND WORKS

The site work cost estimates are as follows:

	<u>Cost Estimate</u>
1. Grading and Siltation Control	<u>\$30,000.00</u>
TOTAL ESTIMATED COSTS	<u>\$30,000.00</u>