

SCHEDULE "A"

LEGAL DESCRIPTION

FIRSTLY:

Part of Lot 84, Plan 717, Town of Pelham, formerly Village of Fonthill, Regional Municipality of Niagara and more particularly described as follows:

COMMENCING at a point in the south limit of said Lot (which point is also in the northerly limit of Canboro Road), distant easterly from the south-west angle of said Lot, 27.5 feet;

THENCE northerly and parallel with the westerly limit of said Lot, 168.5 feet more or less to a point on the northerly limit of said Lot, distant 26 feet more or less east of the northerly angle of said Lot;

THENCE easterly along the said northerly limit, 79.46 feet more or less to a point;

THENCE south 9 degrees, 40 minutes west along the westerly limit of said lands in instrument No. 1437, 129.87 feet more or less to a point in the southerly limit of said Lot No. 84;

THENCE southwesterly along said southerly limit, 83.96 feet more or less to the place of beginning.

As in Instrument No. 763068.

SECONDLY:

Lot 83 and Part of Lot 84, Plan 717, formerly Village of Fonthill, and Part of Lot 2, Concession 8, Town of Pelham, Regional Municipality of Niagara, designated as Parts 1 and 2 on Plan 59R-7056.

SCHEDULE "B"

LANDSCAPE SITE PLAN

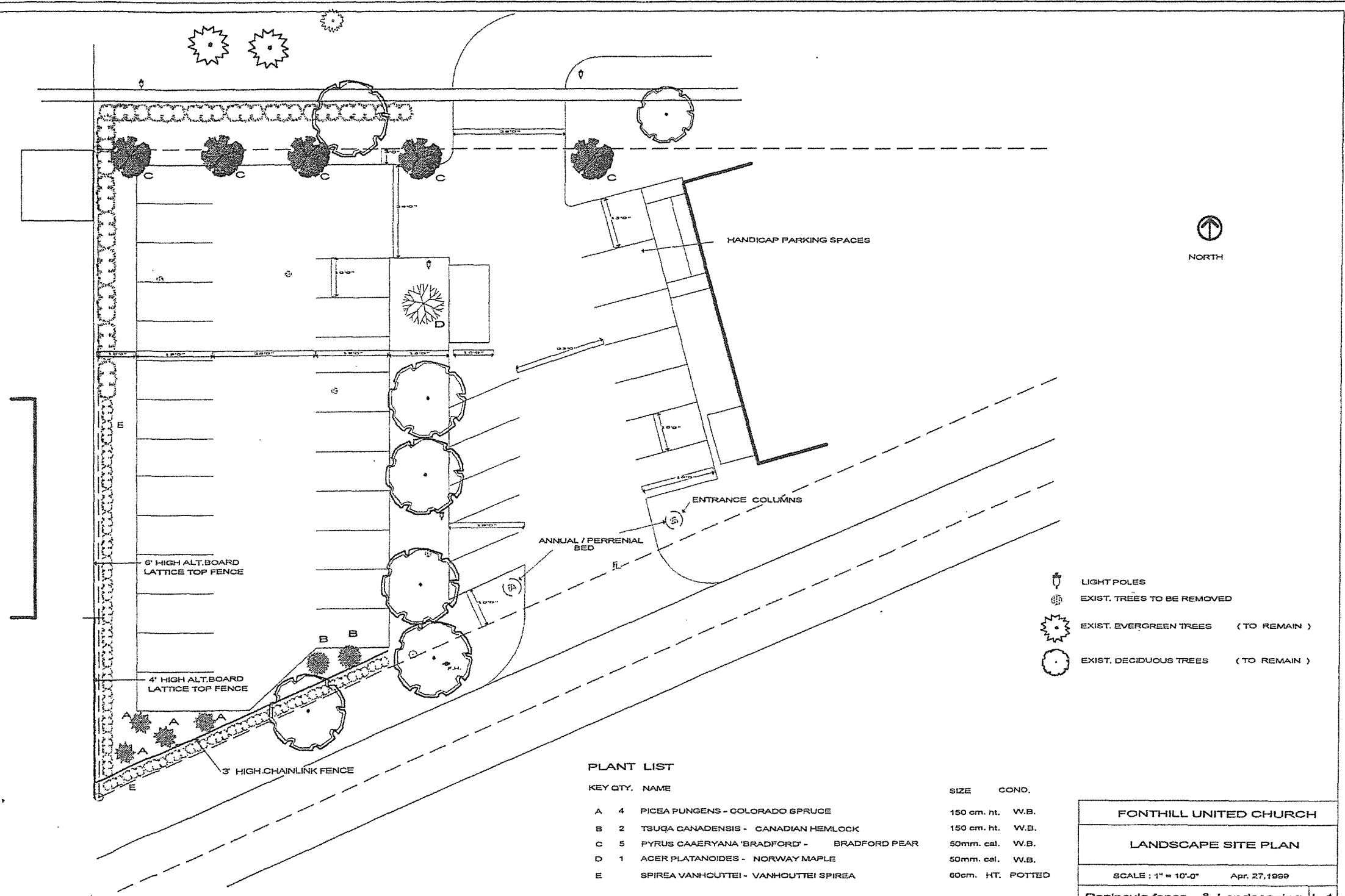

PLANT LIST

KEY	QTY.	NAME	SIZE	COND.
A	4	PICEA PUNGENS - COLORADO SPRUCE	150 cm. ht.	W.B.
B	2	TSUGA CANADENSIS - CANADIAN HEMLOCK	150 cm. ht.	W.B.
C	5	PYRUS CAAERYANA 'BRADFORD' - BRADFORD PEAR	50mm. cal.	W.B.
D	1	ACER PLATANOIDES - NORWAY MAPLE	50mm. cal.	W.B.
E		SPIREA VANHOUTTEI - VANHOUTTEI SPIREA	60cm. HT.	POTTED

FONTHILL UNITED CHURCH
LANDSCAPE SITE PLAN
SCALE : 1" = 10'-0" Apr. 27, 1999
Peninsula fence & Landscaping L-1



SCHEDULE " D "

DEPOSIT FOR FACILITIES AND WORKS

The site work cost estimates are as follows:

	<u>Item</u>	<u>Cost Estimate</u>
1.	Storm Piping	\$4,000.00
2.	Boring	5,000.00
3.	Road reinstatement	500.00
4.	Boulevard reinstatement	<u>500.00</u>
	TOTAL ESTIMATED COSTS	<u>\$10,000.00</u>