

DRAWING FILE: M:\PUBLIC WORKS & UTILITIES DEPARTMENT\Facilities & Structures\Arenas\Projects\Arenas Lunchroom\Drawings\Staff Building Plan NRB-2 Rev July 21, 2014.dwg PLOTTED: Jul 21, 2014 - 1:26pm PLOTTED BY: jf

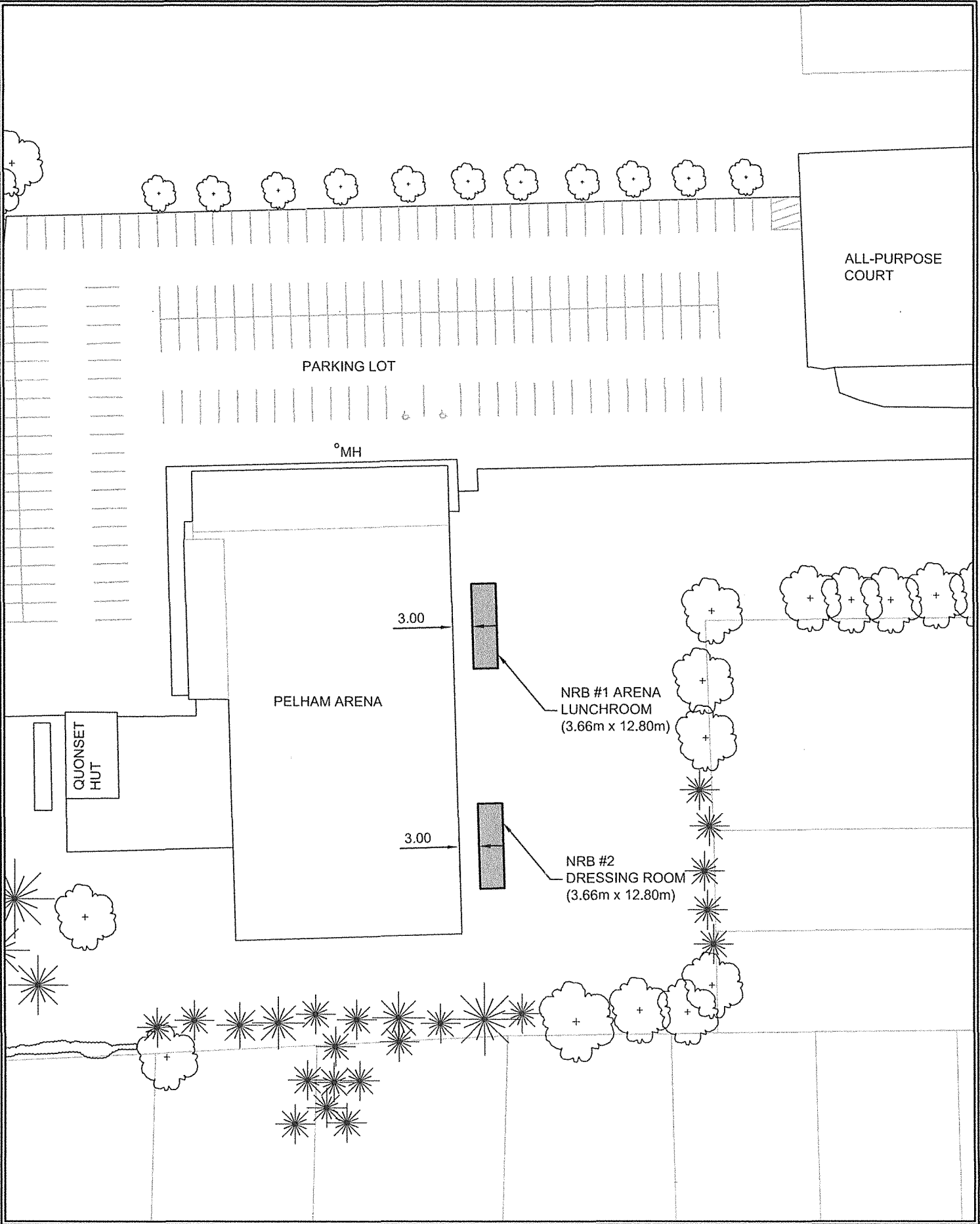

THE CORPORATION OF  
THE TOWN OF PELHAM  
COMMUNITY AND INFRASTRUCTURE  
SERVICES DEPARTMENT



Drawn D.A.Y.  
Design K.H.  
Checked A.R.M.  
Reviewed \_\_\_\_\_

Location  
TOWN OF PELHAM  
Project Name  
PROPOSED ARENA  
DRESSING ROOM

Sheet Title  
SITE PLAN  
Scale  
1:750

Date:  
JULY 2014  
Sheet 1  
of 1  
Drawing No:  
G-02

Schedule "A"

Licensee Priority Use Areas in Pelham Arena - Locations and Illustration

**Schedule “B”**

**Policy Requirements**

In accordance with this agreement the following policies need to be reviewed by the Licensee regarding their operations at Pelham Arena. The full policies will be handed over in hard copy and electronic form by the Town of Pelham at the time the agreement is approved.

The Town of Pelham agrees to send out via email and letter format any amendments to or additional policies that may relate to the agreement.

**Town of Pelham Policies: Zero Tolerance to Violence Policy COMM 16**

Schedule “C”

Concession Stand Minimum Hours of Operation Requirements

In accordance with this agreement the following schedule outlines the minimum hours of operation of the Concessions Stand.

Saturdays	7:00 a.m. – 8:30 p.m.
Sundays	1:00 p.m. – 9:00 p.m.
Mondays	6:30 p.m. – 9:00 p.m.
Tuesdays	6:30 p.m. – 8:45 p.m.
Wednesdays	5:30 p.m. – 8:00 p.m.
Thursdays	5:00 p.m. – 9:00 p.m.
Fridays	7:00 p.m. – 9:45 p.m.
Special Events as may be Scheduled from Time to Time	

## **Schedule “D”**

### **Articles of Incorporation**

The Licensee is a not for profit organization committed to supporting the growth and development of Junior B Hockey in the province of Ontario, and a copy of the Articles of Incorporation of the Licensee are attached as Schedule “D” to this Licence Agreement.